



Safety and installation instructions

Read instructions carefully before placing a pet in this seat. Failure to follow these instructions could result in serious injury. By attaching the Dogrider® pet seat to a bicycle you are acknowledging that you have read and understand the warnings and instructions and understand the hazards involved in transporting a dog on a bike. Only adult bike-riders who are experienced enough should transport the dog with this seat.

Safety instructions

Every time you use the Dogrider dog seat you must check all of the components to make sure the bike seat is properly assembled and that no parts are loose, missing, or broken.

Because of the size and weight associated with transporting dogs on a bike, you may need to react quickly when the animal moves and shifts its weight. It is always necessary to devote yourself to driving.

Be careful when placing your dog in or out of the seat. This should be done in a safe place and out of the reach of other pets. The first few trips should be short, on smooth terrain and in a safe place.

Do not leave the animal unattended on the seat. Due to the higher center of gravity, the bike can tip over if placed on a stand or without adequate support.

You must not allow your dog to distract you while driving. You need to focus on your safe ride, traffic rules, the surrounding area and other cyclists, pedestrians and cars.

If you have any questions or concerns about the safe and correct use of Dogrider, please contact us before using it at: info@dogrider.eu

Installation instructions

1. Place the front platform (table) on the dog seat (tub) and secure it with the three screws, washers and nuts provided. Before tightening, select the correct position of the platform that fits the size of the dog, and only then tighten the screws.

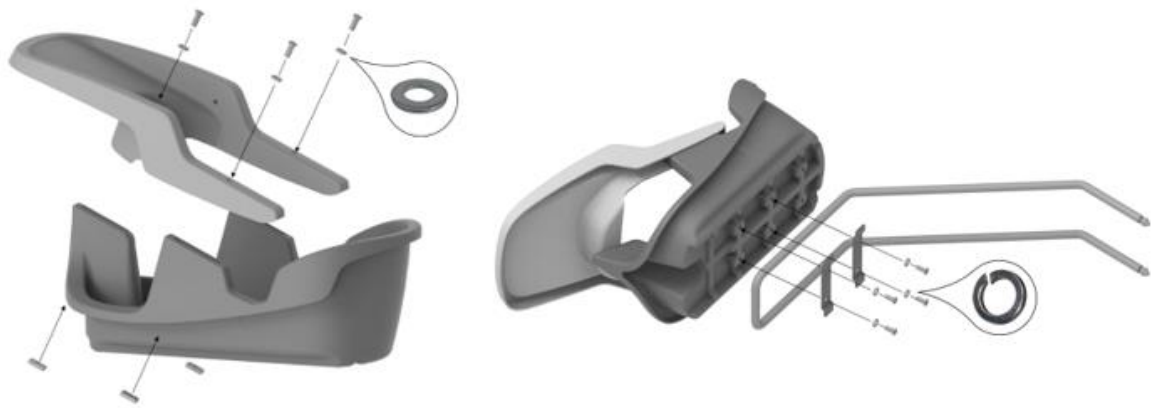

2. Screw the holder to the seat tube with the supplied clamps (2x), nuts (4x) and screws (4x). Mount it as high as possible so that the dogrider doesn't get in the way of you pedaling. (Since the metal bracket also acts as a suspension, there must be a clearance of at least 5 cm between the bracket and the upper frame tube.) First attach the holder to the seat tube, including the plastic sleeves that may overlap on the other side of the tube. The derailleur-brake cables can be inserted into the holder with cable ducts on both sides. The derailleur-brake cables can also run outside the holder. Before driving, check the function of the brakes and the derailleur and make sure that the cables are not jammed in the bracket and that everything works smoothly and without restriction.

3. Insert the metal bracket into the holder until it clicks into place. (Since the metal bracket also acts as a suspension, there must be a clearance of at least 5 cm between the bracket and the upper frame tube.) The metal console must not restrict the steering angle.



4. Now mount the already assembled dog seat (tub and table) on the metal bracket. Mount the dog seat as forward as possible so that the dog seat doesn't get in the way of you pedaling. The dog seat must not restrict the steering angle. The installation is carried out with the supplied 4 screws, 4 washers and 4 nuts as well as two clamps.
5. To remove the metal bracket from the holder, press the button on the holder. The metal bracket can also be locked with the two red keys provided.

Safety harness

Your dog must always be secured in the dog seat with the safety harness provided.

1. In the sitting position, place your dog as far back in the seat as possible.
2. Attach and place the rear buckle over the dog's shoulder and evenly adjust the rear straps.
3. Place the strap around your dog's neck so that it is directly under the dog's own collar.
4. Attach the front buckle and adjust the strap to the appropriate size.
5. When your dog is in a sitting position with the front paws along the upper platform or with the front paws down, adjust the front straps so that your dog is always securely strapped in. Like a seat belt on a child seat, this harness is designed to prevent unnecessary movement so your dog can stay in a safe position and enjoy the ride.

